



ELECTRIC TOILET

15440 DC 12V & 24V

With luxury home type bowl, plastic seat & cover

Switch box included

15407 Delux type, plastic seat and cover (Page 13)

15441 Base unit (P/No. 22-1, 23, 37, 39, 42, 54 & 64)

15421 Repair kits (P/No. 21, 26-30)

15420A Pump unit, 12V & 24V
(P/No. 16-21, 26-35, 37-41, 43, 57, 58 & 65)

15420M Motor only, 12V & 24V

15420S Switch box, 12V & 24V (P/No. 48-53)

KEY	DESCRIPTION	Q'TY
1-2	Closestool Body	1
2-1	Seat Cushion	1
3-1	Closestool Cover	1
4		
5-1	Set bolt	2
6-1	Coupling+Cover	2
7-1	Union screw	2
8-1	Wing Nut	2
9		
10		
11	Joint	1
12	Joint Packing	1
13	Flat Washer	1
14	Joint Nut	1
15		
16	Wearplate	1
17	Sleeve Kit	1
18	Centrifugal Impeller	1
19	Macerator Housing	1
20	Razor Blade/upper	1
20-1	Razor Blade/lower	1
21	Gasket	1
22-1	Base	1
23	Flapper Valve	1
24		
25	Adaptor	1
25-1	Adaptor	1
26	Slinger	1
27	Body	1
28	Gasket	1
29	Flexible Impeller	1
30	Seal	1
31	Motor	1
32	Screw	2
33	Screw	2
34	O Ring	1
35	Set Screw	1
36	Flat Washer	4
* 37	Flat Washer	4
38	Spring Washer	1
* 39	Hexagon Nut	4
40	Screw	4
41	Spring Washer	4
42	Screw	3
43	Flat Washer	4
44	Base Packing	1
45	Hexagon Bolt	4
46	Plastic Washer	4
47-1	Hose	2
48	Switch Box	1
49	Cover	1
50	Fuse & Fuse Holder	1
51	Switch	1
52	Gasket	1
53	Tapping Screw	4
54	Joint	1
55		
56	Hexagon Nut	4
57	Flat Washer	1
58	Spring Washer	1
59	Cramp	4
60	Flat Washer	2
61		
62	Anchor Plate	1
63	Pipe Joint	1
64	Pipe Bender	1
65	Rubber washer	4
66	Inner Pipe Joint	1
67	O Ring	4

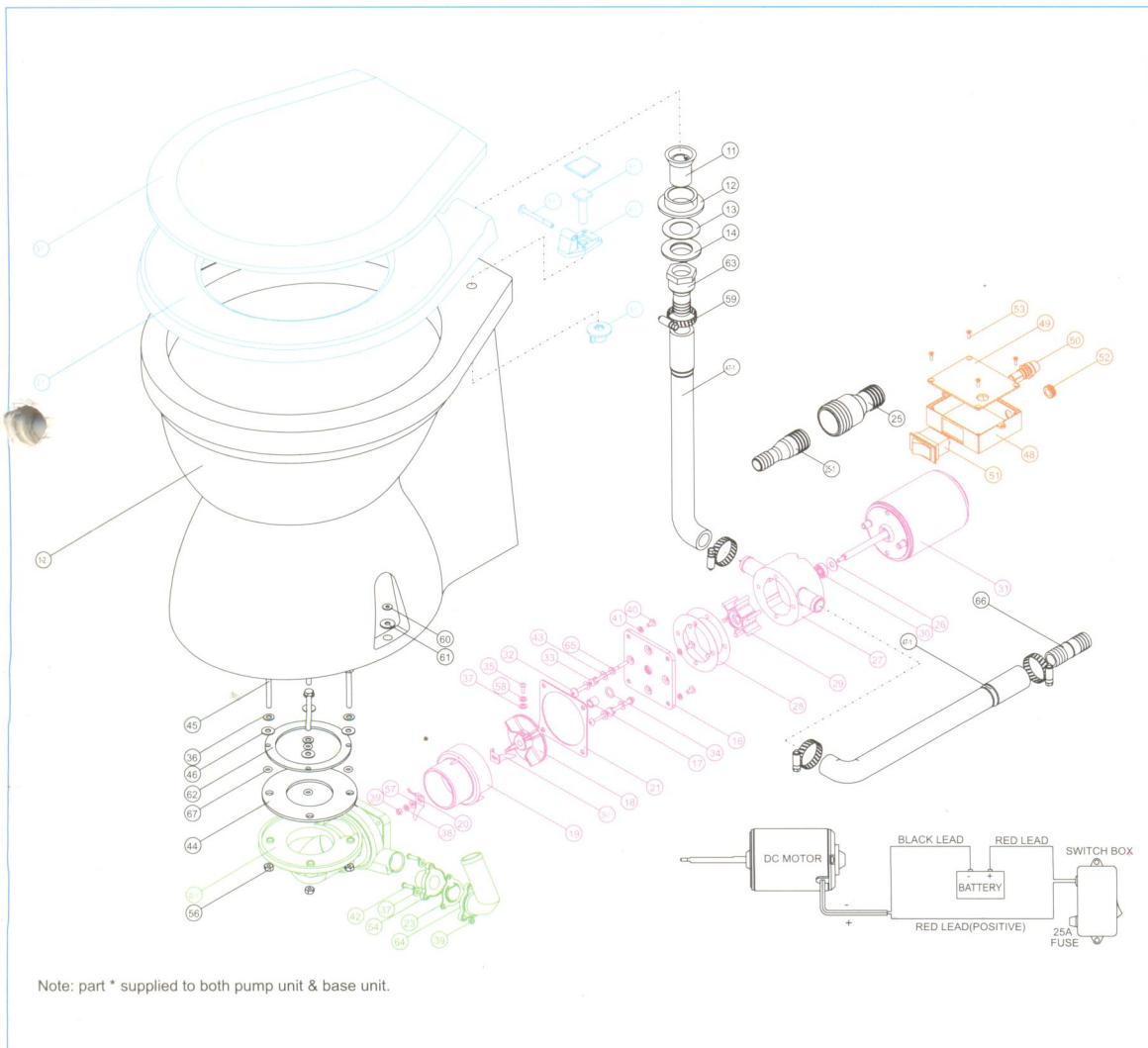

Note: part * supplied to both pump unit & base unit.