

# YOUTHFUL MARINE TOILET



## ELECTRIC TOILET

**15430** DC 12V, 24V

With large bowl & deluxe plastic seat & cover  
Switch box included

**15407** Delux type, plastic seat and cover (Page 13)

**15420A** Pump unit, 12V & 24V  
(P/No. 16-21, 26-35, 37-41, 43, 57, 58 & 65)

**15420B** Base & motor, 12V & 24V (P/No. 11-24, 26-46, 54-58, 65)

**15420C** Motor and macerat complete units assembled, 12V & 24V  
(P/No. 16-22, 26-35, 37-41, 43, 57, 58 & 65)

**15420M** Motor only, 12V & 24V

**15420S** Switch box, 12V & 24V (P/No. 48-53)

**15421** Repair kits (P/No. 21, 26-30)

**15422** Base unit (P/No. 22, 23, 24, 37, 39, 42 & 54)

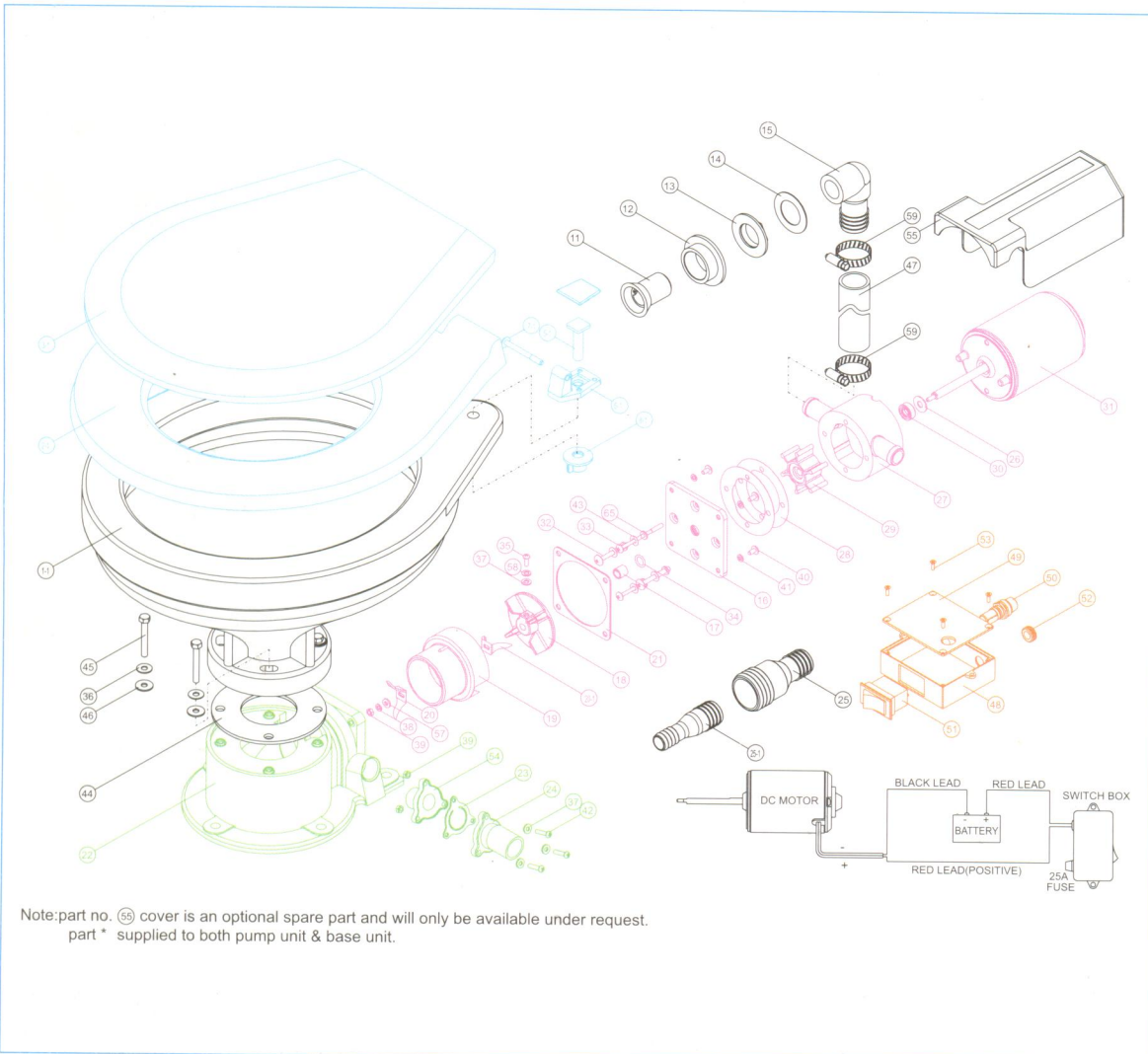

Note: part no. 55 cover is an optional spare part and will only be available under request.  
part \* supplied to both pump unit & base unit.

KEY	DESCRIPTION	QTY
1-1	Closestool Body	1
2-1	Seat Cushion	1
3-1	Closestool Cover	1
4		
5-1	Set Bolt	2
6-1	Coupling+Cover	2
7-1	Union Screw	2
8-1	Wing Nut	2
9		
10		
11	Joint	1
12	Joint Packing	1
13	Flat Washer	1
14	Joint Nut	1
15	Elbow	1
16	Wearplate	1
17	Sleeve Kit	1
18	Centrifugal Impeller	1
19	Macerator Housing	1
20	Razor Blade/upper	1
20-1	Razor Blade/lower	1
21	Gasket	1
22	Base	1
23	Flapper Valve	1
24	Discharge Port	1
25	Adaptor	1
25-1	Adaptor	1
26	Slinger	1
27	Body	1
28	Gasket	1
29	Flexible Impeller	1
30	Seal	1
31	Motor	1
32	Screw	2
33	Screw	2
34	O Ring	1
35	Set Screw	1
36	Flat Washer	4
37	Flat Washer	4
* 38	Spring Washer	1
* 39	Hexagon Nut	4
40	Screw	4
41	Spring Washer	4
42	Screw	3
43	Flat Washer	4
44	Base Packing	1
45	Hexagon Bolt	4
46	Plastic Washer	4
47	Hose	1
48	Switch Box	1
49	Cover	1
50	Fuse & Fuse Holder	1
51	Switch	1
52	Gasket	1
53	Tapping Screw	4
54	Joint	1
55	Cover	1
56		
57	Flat Washer	1
58	Spring Washer	1
59	Clamp	2
65	Rubber Washer	4