

15420



ELECTRIC TOILET

15420 DC 12V, 24V

With small bowl & standard plastic seat & cover
Switch box included

15404 Standard plastic seat and cover (Page 12)

15420A Pump unit, 12V & 24V
(P/No. 16-21, 26-35, 37-41, 43, 57, 58 & 65)

15420B Base & motor, 12V & 24V
(P/No. 11-24, 26-46, 54-58, 65)

15420C Motor and macerat complete units assembled, 12V & 24V
(P/No. 16-22, 26-35, 37-41, 43, 57, 58 & 65)

15420M Motor only, 12V & 24V

15420S Switch box, 12V & 24V (P/No. 48-53)

15421 Repair kits (P/No. 21, 26-30)

15422 Base unit (P/No. 22, 23, 24, 37, 39, 42 & 54)

KEY	DESCRIPTION	QTY
1	Closestool Body	1
2	Seat Cushion	1
3	Closestool Cover	1
4	Washer	2
5	Square Neck Bolt	2
6	Support	2
7	Support Packing	2
8	Wing Nut	2
9	Seat Cushion Packing	3
10	Closestool Cover Packing	4
11	Joint	1
12	Joint Packing	1
13	Flat Washer	1
14	Joint Nut	1
15	Elbow	1
16	Wearplate	1
17	Sleeve Kit	1
18	Centrifugal Impeller	1
19	Macerator Housing	1
20	Razor Blade/upper	1
20-1	Razor Blade/lower	1
21	Gasket	1
22	Base	1
23	Flapper Valve	1
24	Discharge Port	1
25	Adaptor	1
25-1	Adaptor	1
26	Slinger	1
27	Body	1
28	Gasket	1
29	Flexible Impeller	1
30	Seal	1
31	Motor	1
32	Screw	2
33	Screw	2
34	O Ring	1
35	Set Screw	1
36	Flat Washer	4
* 37	Flat Washer	4
* 38	Spring Washer	1
* 39	Hexagon Nut	4
40	Screw	4
41	Spring Washer	4
42	Screw	3
43	Flat Washer	4
44	Base Packing	1
45	Hexagon Bolt	4
46	Plastic Washer	4
47	Hose	1
48	Switch Box	1
49	Cover	1
50	Fuse & Fuse Holder	1
51	Switch	1
52	Gasket	1
53	Tapping Screw	4
54	Joint	1
55	Cover	1
56		
57	Flat Washer	1
58	Spring Washer	1
59	Clamp	2
65	Rubber washer	4

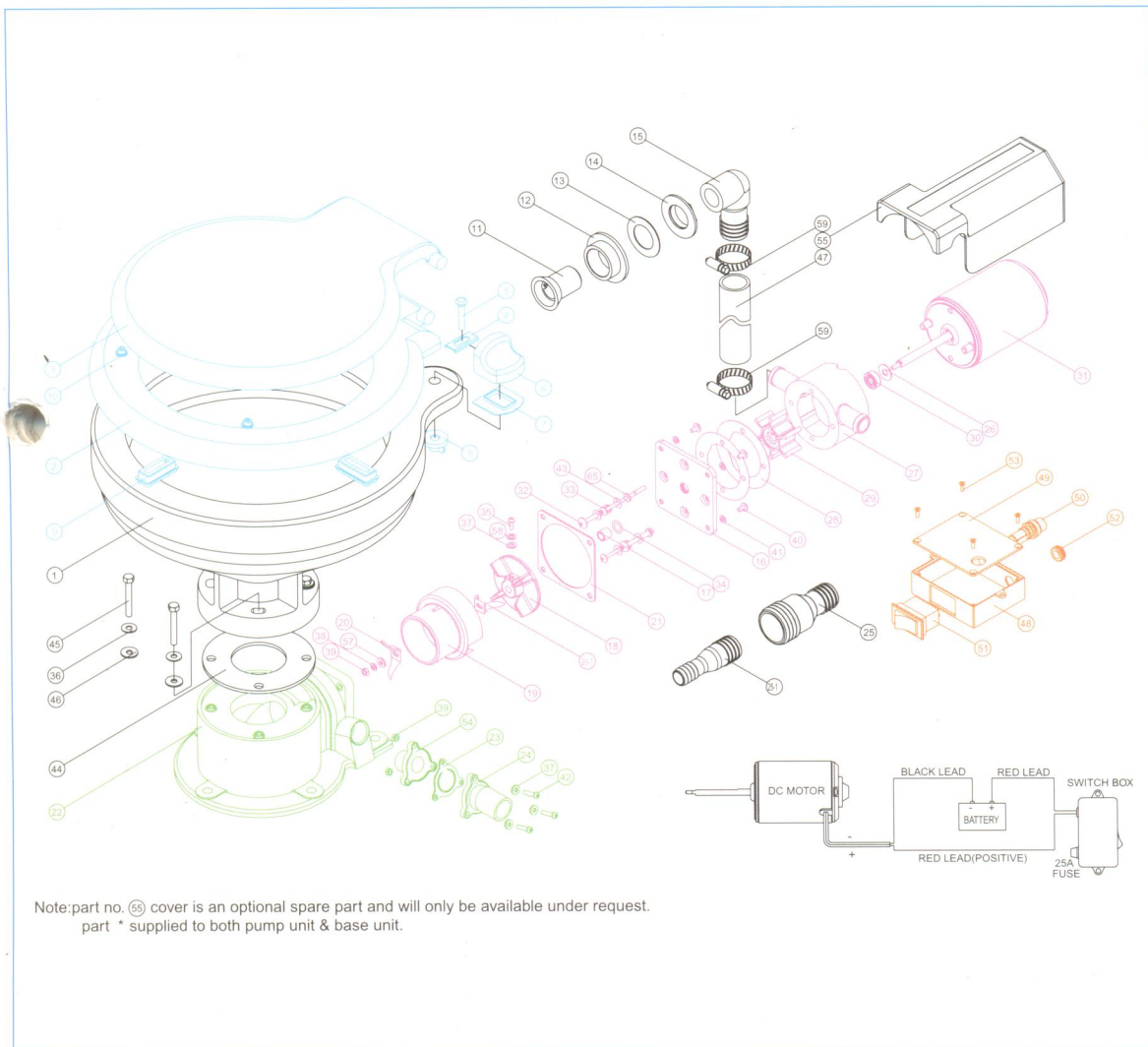

Note: part no. 55 cover is an optional spare part and will only be available under request.
part * supplied to both pump unit & base unit.